

PARKING ON DENMARK STREET

Dear Parents and Carers

Re: Serious risk to child safety- parking on Denmark Street

It's ironic that the biggest threat to our children's safety is parents themselves, namely the minority who persist on parking inappropriately on Denmark Street.

As you may be aware the situation outside of our school is becoming an issue for the safety of our children and we are concerned over the number of reported near-misses that relate to careless parking and driving. The School fear that it's only a matter of time before a young child is either seriously injured, or in the worst possible scenario, killed by a parent during the peak drop off and pick up times or by parking on the pavements outside the main entrance or disregarding the resident only parking scheme.

We are staggered that there is still a minority of our parents who refuse to drive and park sensibly (despite the many articles in newsletters and polite requests from staff, police and local authority officers) and walk the few extra yards to help ensure children are safe when walking, scooting or cycling into school.

The school benefits from being in a quiet cul-de-sac but these benefits are compromised by thoughtless individuals who cannot park appropriately.

So to help tackle this serious risk, the school have decided to:

Highlight the parking restrictions, in this flyer, to parents or carers who choose to ignore road signs and road markings and continue to put our school children at risk

Personally send a letter to any parent who persists in ignoring our requests, inviting them to come and discuss this issue in school;

Provide the relevant enforcing authority with photographic evidence of anyone who breaks the law;







Please do not park in the red area

The full set of enforceable traffic regulation orders / markings are on the reverse of this flyer, provided by Sefton.

We hope the next correspondence on this issue is not to offer our sympathies to a family whose child has been injured or worse.



Key to Restriction Types Displayed

-  Residents Parking Place At any time
-  Disabled Persons Parking Place At any time
-  Ambulance Parking Place At any time
-  No waiting at any time

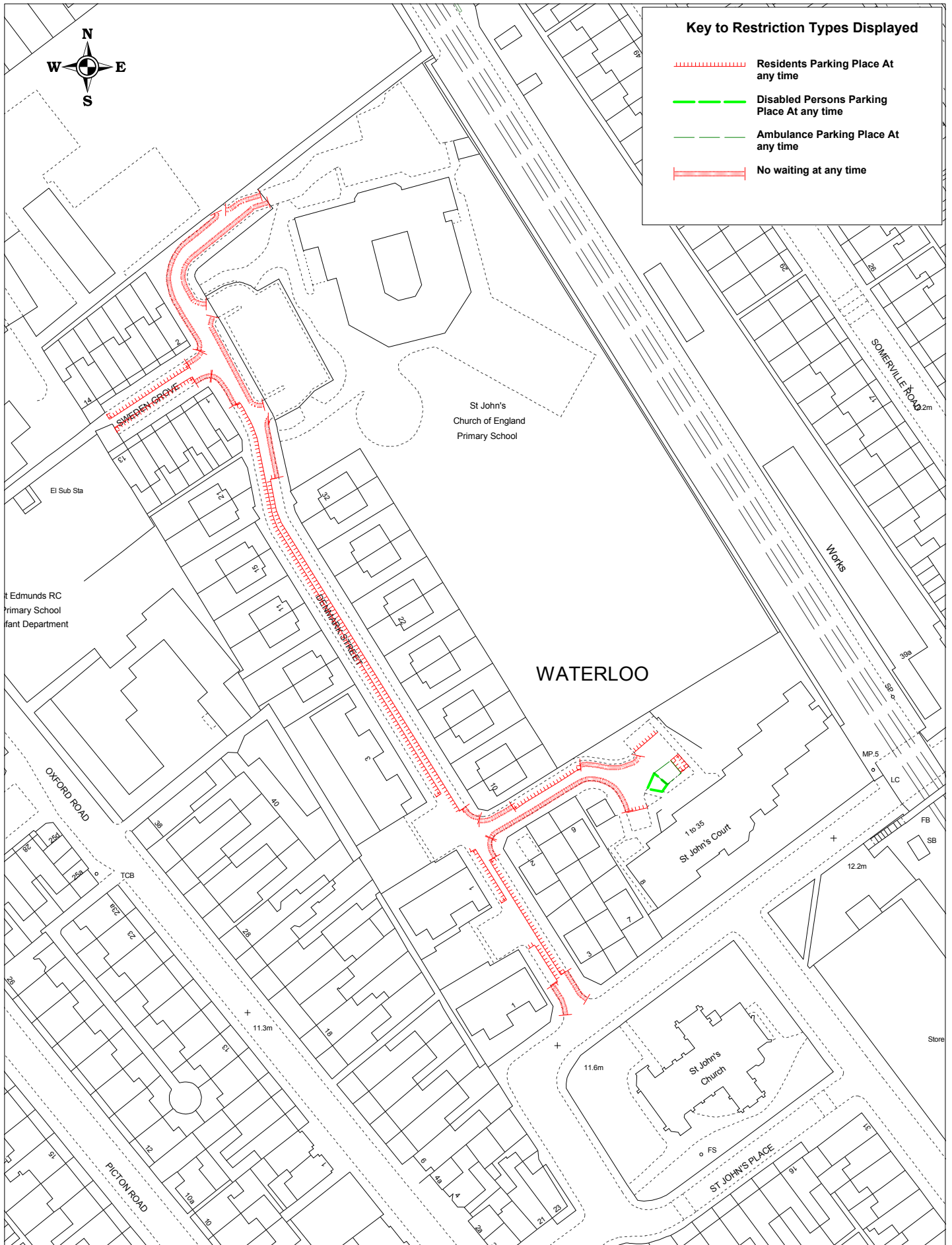

© Crown copyright. All rights reserved

Licence No. 2003

Denmark Street & Sweden Grove, Waterloo Enforceable parking restrictions

SCALE	1 : 1250
DATE	17/11/2016
DRAWING No.	
DRAWN BY	

